

MTP-10/16/25

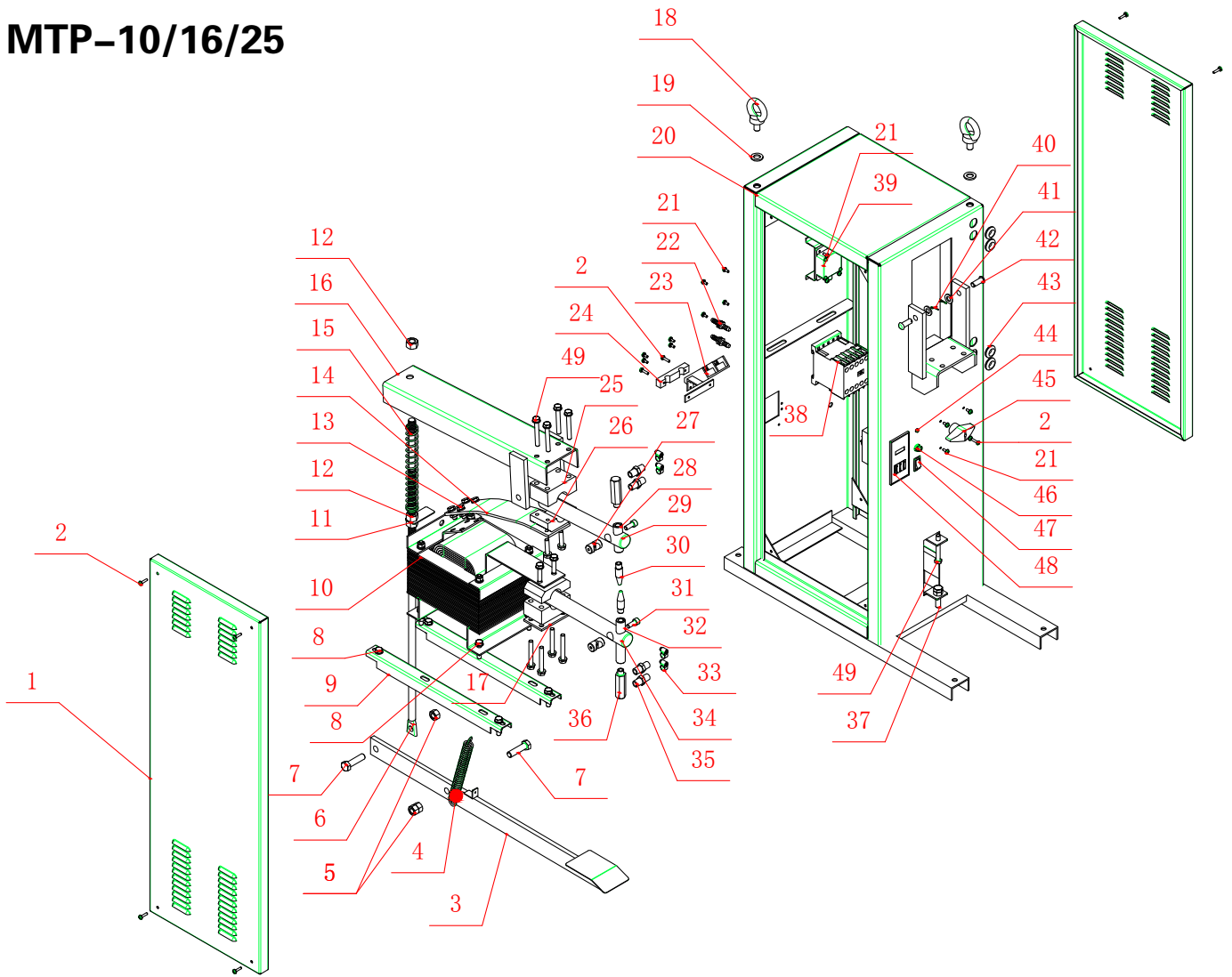

No.	Description	QTY	No.	Description	QTY
1	04.03.301.027 Side Plate	2	26	06.03.004.001 Electroder fixator -02	2
2	03.05.007.014 H-shape cross recess pan head screw GB/T 818 M4 x 18	11	27	06.01.012.007 Hasp	2
3	04.03.301.005 Foot Rest	1	28	06.03.003.008 Upper electrode	1
4	03.04.005.007 Tension Spring	1	29	06.03.003.006 Upper electrode bar	1
5	03.05.006.021 Hexagon nut GB/T 6170 M12	3	30	06.03.003.009 Electrode tip	2
6	03.05.006.017 Screw	1	31	03.05.007.018 Hexagon socket and head screw GB/T 70.1 M8 x 20	2
7	03.05.007.011 Hexagon bolt GB/T 5780 M12 x 45	2	32	06.03.003.007 Lower electrode	1
8	03.05.007.017 Hexagon bolt GB/T 5780 M8 x 35	12	33	03.05.016.007 Hose clamp	4
9	02.03.003.005 Transformer bracket	2	34	06.03.003.005 Lower electrode bar	1
10	02.03.003.016 Transformer	1	35	03.05.005.012 Hexagon connector tip 1/4	4
11	06.01.012.005 Touch plate	1	36	03.05.005.013 Hexagon connector	2
12	03.05.006.023 Hexagon nut GB/T 6170 M14	3	37	03.05.007.027 Hexagon bolt GB/T 5780 M10 x 40	1
13	03.05.006.015 Hexagon blot GB/T 5780 M8x 25	4	38	02.05.006.021 AC contactor	1
14	06.03.005.005 Electroder connecting plate	1	39	02.05.007.050 Position limit switch	1
15	03.05.005.010 Compression spring	1	40	03.05.008.011 Cotter GB/T 91 2 x 14	2
16	04.03.301.007 Arm	1	41	03.05.006.031 Flat washer GB/T 97.1 10	2
17	06.03.006.002 Lower electrode collets	1	42	03.05.008.012 Cotter	2
18	03.05.007.020 G-shape lifting bolt GB 825 B M12	2	43	08.10.004.021 Wire saddle	4
19	03.05.006.030 Flat washer GB/T 95 12	2	44	02.03.004.056 Indicator Light	1
20	04.03.301.030 Shell-00	1	45	02.05.003.021 Rotary switch	1
21	03.05.007.015 H-shape cross recess pan head screw GB/T 818 M4 x 10	16	46	02.05.010.017 Safty catch	1
22	06.01.010.003 Pagoda splice	2	47	02.05.003.087 Rocker switch	1
23	06.01.010.007 Wiring board	1	48	02.04.010.067 Time relay	1
24	06.01.011.003 Line holder	1	49	03.05.007.016 Hexagon bolt GB/T 5780 M8 x 60	13
25	06.03.004.002 Electroder fixator -01	2			